



359 Sweetwater Road Mullengandra NSW

3 2 6

Discover an unparalleled oasis lifestyle on this remarkable property, featuring a range of exceptional amenities. Set on 1.3 hectares (3.54 acres) and located just 25 minutes from Albury with easy freeway access, this stunning estate is offered at \$875,000.

Key Features:

- ? Three spacious bedrooms with built-in and walk-in robes
- ? Ensuite bathroom
- ? Family/lounge area with vaulted ceilings
- ? Beautiful east-facing kitchen with new appliances
- ? Reverse cycle air conditioning
- ? 5kva solar system
- ? Integrated watering system
- ? Shade perimeter verandahs
- ? 47,000-liter tanks, dam, and bore for water supply
- ? Orchard with a variety of fruit trees, excellent vegetable garden.
- ? Historic shearing shed
- ? Double carport
- ? Chooks / Ducks / Birdlife / alpaca
- ? Stunning tapestry of mature garden colour

This elegantly renovated property offers a generous and roomy floor plan with luxury finishes throughout. It has

Price : \$875,000
Building Size : 140 sqm
Land Size : 1.34 ha
View : <https://www.brianphegan.com.au/sale/nsw/murray-region/mullengandra/residential/house/7806321>



Brian Phegan
02 6040 7173

0 1 2 3 4



approx. scale (m)

This plan is a sketch, and all data shown is general only.

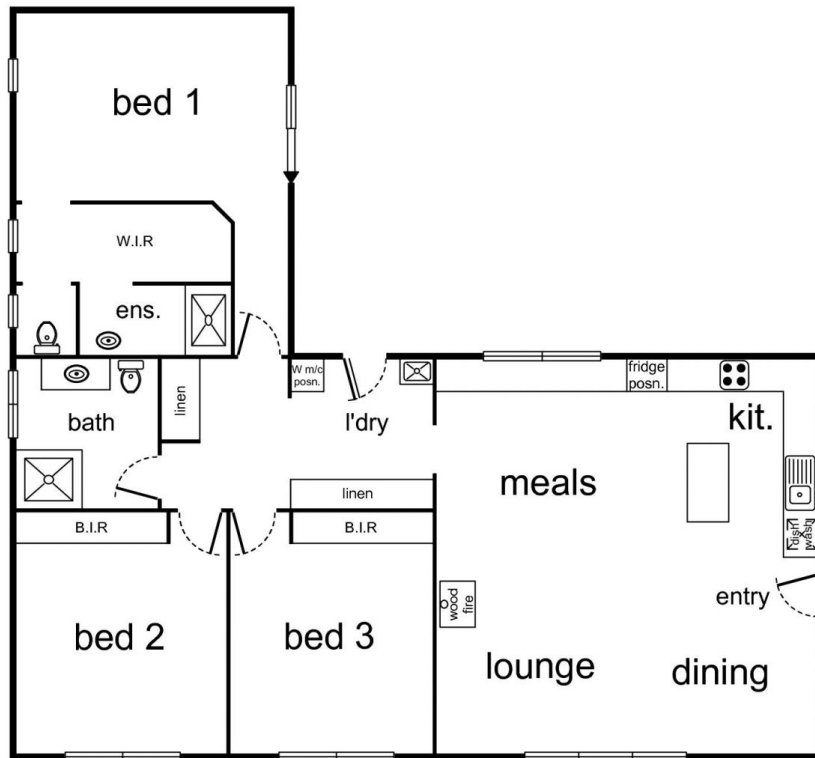

359 Sweetwater Road, Mullengandra