



## 27 Pech Avenue Jindera NSW

3 2 4

Comprehensive quality in this custom design, with a Quiet location.

Three Bedrooms B.I.R, W.I.R, ensuite, ceiling fans ( plus Study.nook ) North facing living areas. Beautifully equipped kitchen. Stone benchtops, island bench with waterfall ends. Electric under bench oven, gas cooktop, dishwasher. Thoughtfully planned design. Full dress light and bright decor. Tastefully selected finishes. Seamless flow to north facing alfresco entertaining area. 2016 Build. Formal and family living zones. Refrigerated reverse cycle heating and cooling ducted throughout. Natural gas infinity HWS. Three wc's. Low step entry. Minimal maintenance Home. 4 garage one with wc, hot and cold water. Backs onto a reserve. A home not to be missed !!!

**Building Size** : 135 sqm  
**Land Size** : 656 sqm  
**View** : <https://www.brianphegan.com.au/sale/nsw/murray-region/jindera/residential/house/7451377>



**Brian Phegan**  
**02 6040 7173**



0 1 2 3 4



approx. scale (m)

This plan is a sketch, and all data shown is general only.

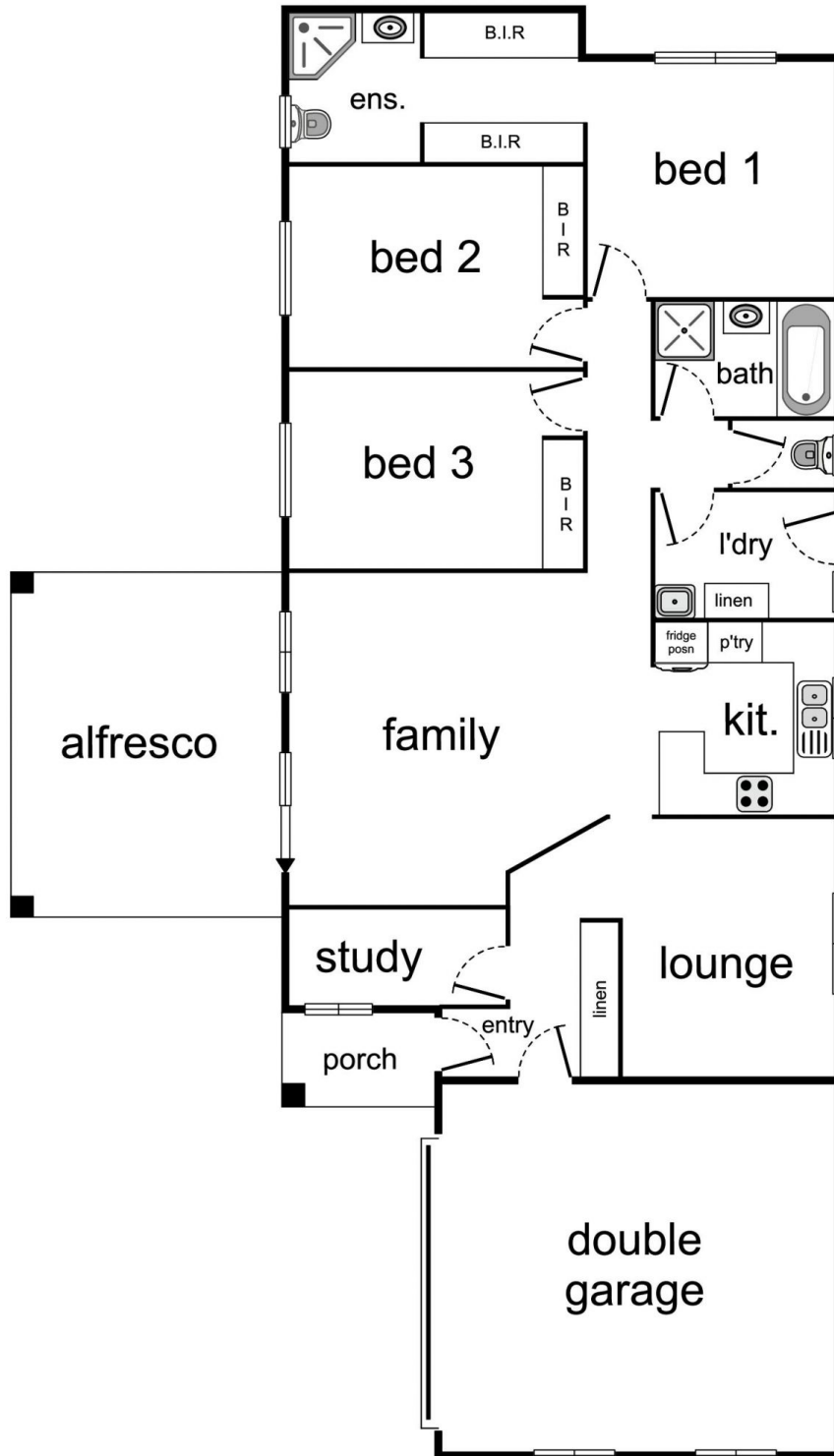

27 Pech Avenue, Jindera