



1/110 Greta Drive Hamilton Valley NSW

4 2 2

Comprehensive quality in this custom design. Quite Location. Caravan friendly.
4 big bedrooms B.I.R & en-suite. Modern full bathroom. Two living areas. Beautifully equipped kitchen, generous island bench, gas cooktop with electric under bench oven, dishwasher. Ducted gas heating, ducted evaporative cooling. Loads of storage. Thoughtfully planned design. Full dress light and bright decor. Tastefully selected finishes. Seamless flow to north facing alfresco pergola entertaining area. 2015 Build. Formal and family living zones. Natural gas HWS. No step entry. Low maintenance Home. Double deep garage with remote and internal access. Small easy care yard on a neighborhood plan with side access for boat or van.
A home not to be missed !!!

Building Size : 155 sqm
Land Size : 421 sqm
View : <https://www.brianphegan.com.au/sale/nsw/murray-region/hamilton-valley/residential/townhouse/7132977>



Brian Phegan
02 6040 7173



This plan is a sketch, and all data shown is general only.
 NB: All stated dimensions are approximate only & should not be taken as definite.

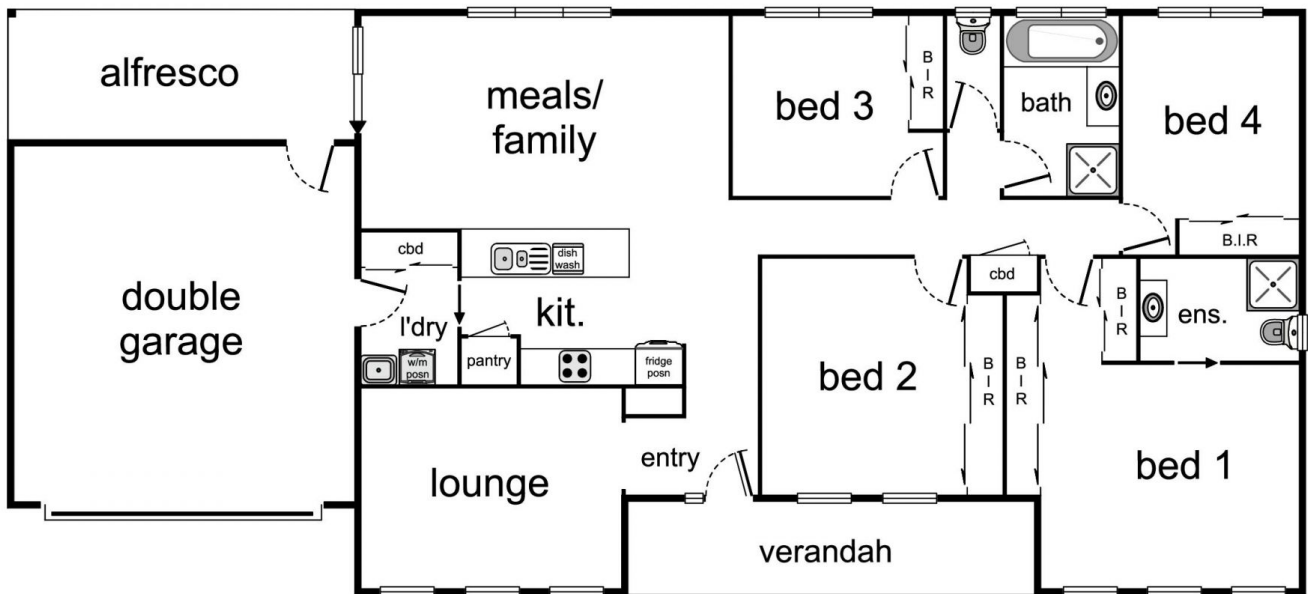

1/110 Greta Drive, Hamilton Valley