



### 629 Poole Street Albury NSW

3 2 2

A rare chance to find an affordable North facing Home so close to the city.

No Step entry, private Courtyard low maintenance garden, double deep garage with internal entry. This modern character Home offers a charming ambiance, high spec finish, easy care floating floors, reverse cycle refrigerated air conditioning effortless open plan with tall ceilings. North facing bright and light living rooms, relaxing box reading window with open outlook.

Instantaneous Hot water, Solar 4kw 12 panel system means low energy costs.

629 Poole Street is a property not to be missed.

**Price** : \$ 390,000  
**Building Size** : 150 sqm  
**View** : <https://www.brianphegan.com.au/sale/nsw/murray-region/albury/residential/house/5932620>



**Brian Phegan**  
02 6040 7173



0 1 2 3 4  
approx. scale (m)  
This plan is a sketch, and all  
data shown is general only.

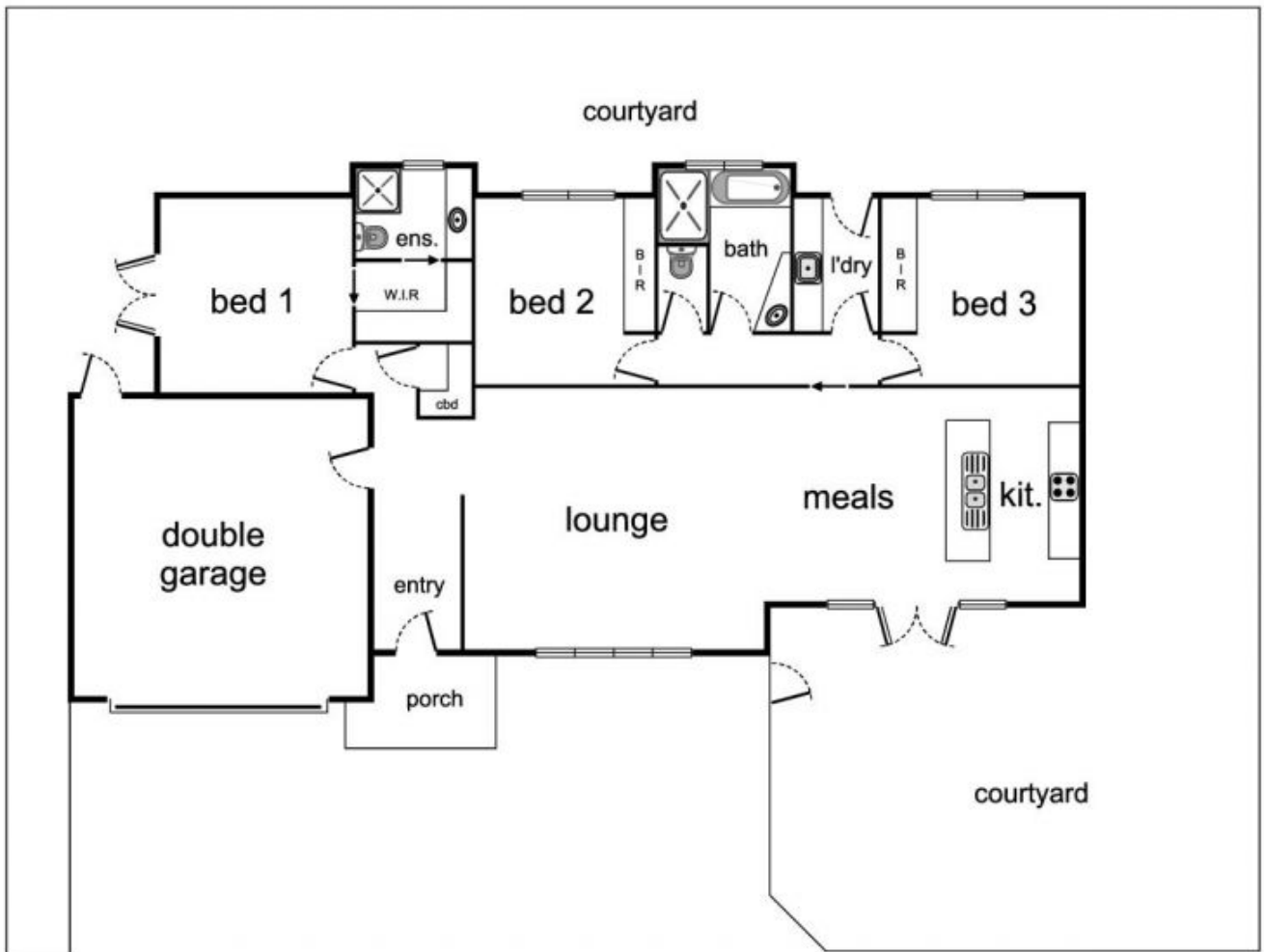

629 Poole Street, Albury