



222 Fletcher Street East Albury NSW

3  1  5 

Situated in a quiet street, walking distance to sports fields and CBD.

A gently elevated home with drive through access to a North facing back yard.

The correct orientation for lower reliance on mechanical heating and cooling. Period style stone work in entry garden walls and drive.

Tall ceilings, three bedrooms, BIR in two, bathroom with spa and separate shower. Beautiful Murray Pine floors. Lounge, dining and family areas. Refrigerated air conditioning, ducted gas heating, blackwood kitchen, electric wall oven and hot plates, step in pantry, dishwasher, exterior awnings, BBQ deck, carport, garage, and under house storage.

222 Fletcher Street is a home not to be missed.

Contact Brian Phegan 0418 578 079

Price : \$ 320,000
Building Size : 137 sqm
Land Size : 668 sqm
View : <https://www.brianphegan.com.au/sale/nsw/murray-region/east-albury/residential/house/5932616>



Brian Phegan
02 6040 7173

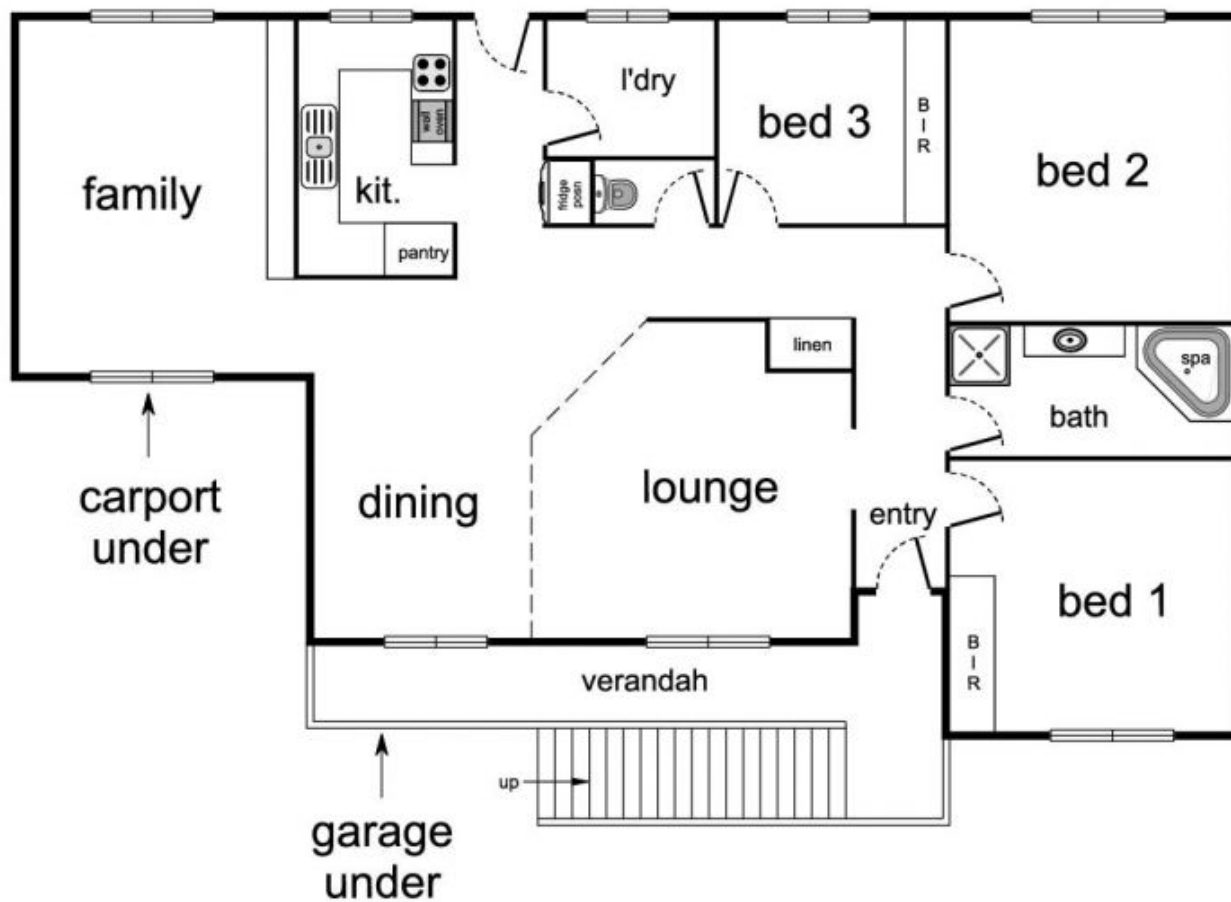

222 Fletcher Street East Albury