





**235 Rivergum Drive East Albury NSW**

**3**  **2**  **2** 

### Highlights

Location Matters  
Open Plan  
Near New  
Rear Access  
Welcoming Decor

Plus  
Leaseable \$380 - \$390 pw  
Suits Retiree  
First Home  
Investment  
Ducted Gas  
Evaporation Cooling  
Double Garage  
Dennis Family Built 2010

**Price** : \$ 375,000  
**Building Size** : 151 sqm  
**Land Size** : 696 sqm  
**View** : <https://www.brianphegan.com.au/sale/nsw/murray-region/east-albury/residential/house/5932576>



**Brian Phegan**  
**02 6040 7173**

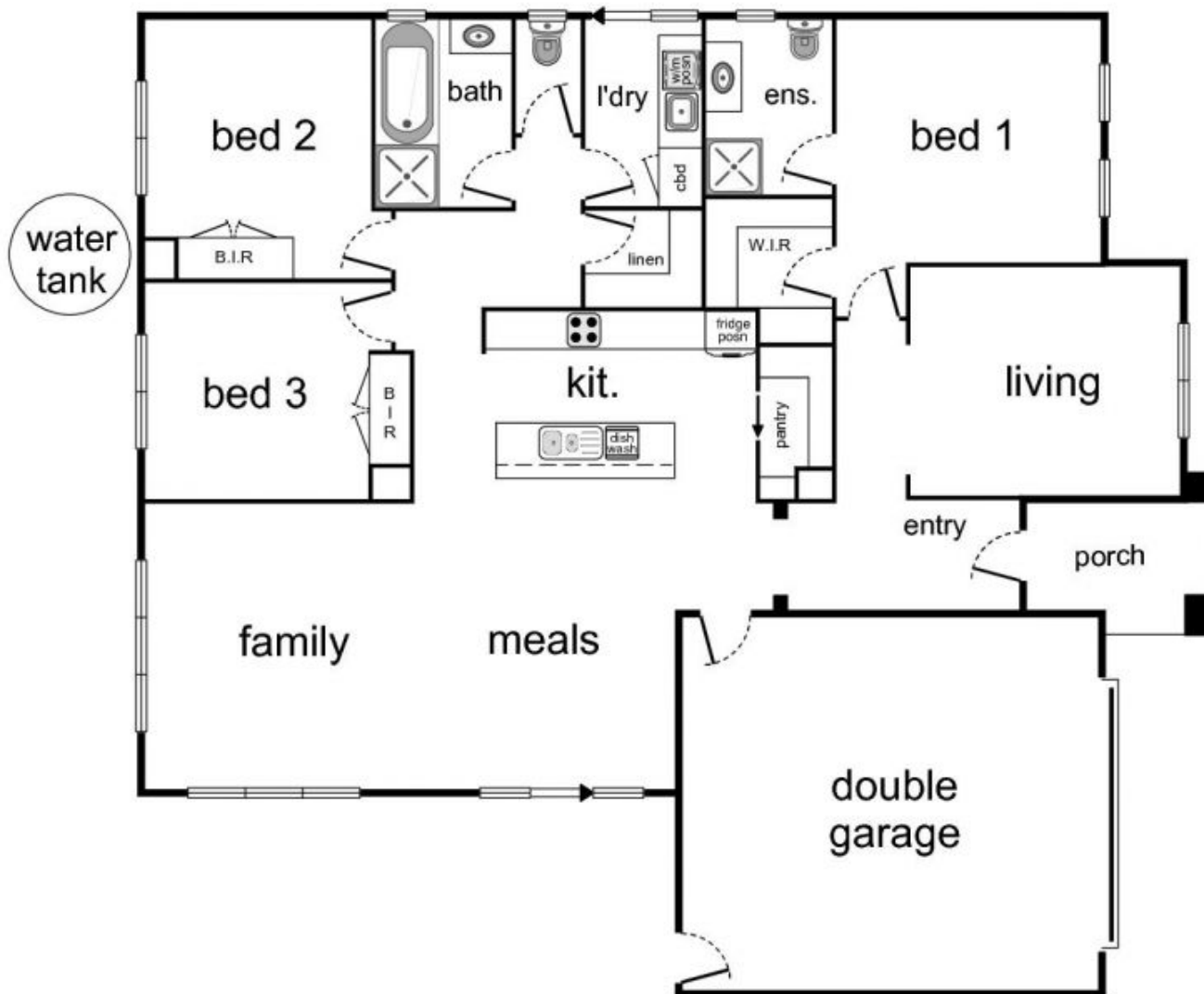

235 Rivergum Drive East Albury