

### 488 Hovell Street Albury NSW

3 1 3

If you are a little gifted with a paint brush and will not flinch at the thought of some D.I.Y improvements, then this central home could be just for you.

It's positioned just three blocks from Dean Street and close to Parkland.

You can appreciate the 1950's period features as well as the bright and light floor plan.

Ideal for an extension into the North facing back yard.

#### Highlights

Wonderful Position  
Potential Plus  
Do a little or a lot  
Build on or out  
Reverse cycle refrigerated air conditioning  
Murray Pine floors.

**Price** : \$ 269,000  
**Land Size** : 670 sqm  
**View** : <https://www.brianphegan.com.au/sale/nsw/murray-region/albury/residential/house/5932521>



**Brian Phegan**  
02 6040 7173

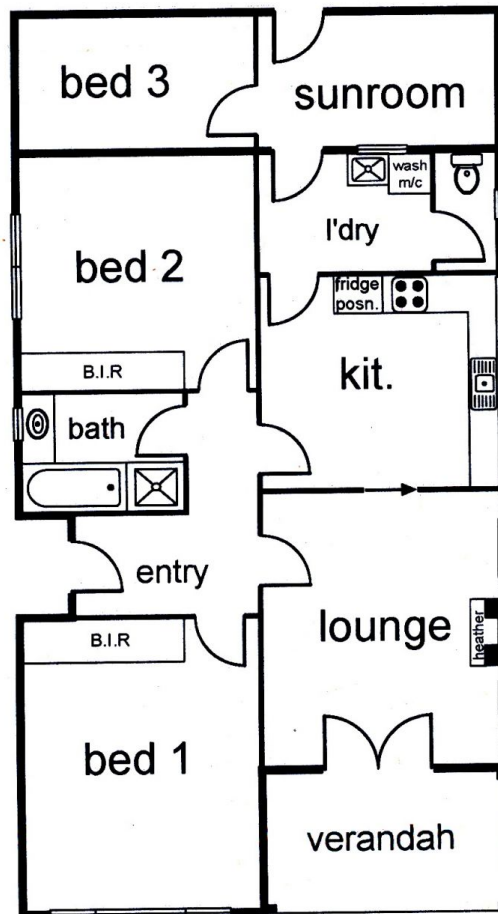

488 Hovell Street, Albury